

Wall & ceiling lighting fitting

5905339196415

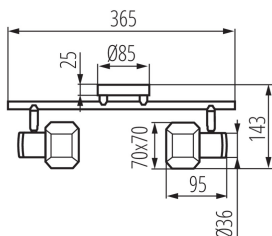

Kanlux GLASO is a family of spot beam lamps (ceiling and wall). Thanks to adjustment, you can freely set the angle of light. The shape of the lamps and interesting design of the glass lampshades emphasize a character of retro interiors and chromium-plated additives will add a subtle cut to modern interiors.

GENERAL DATA:

Colour: chrome

Place of assembly: wall mounted, ceiling mounted

Place of application: Indoors

Minimum distance from the illuminated object: 0,5m

Light source included: no

Length [mm]: 365

Width [mm]: 95

Height [mm]: 143

TECHNICAL DATA:

Rated voltage [V]: 220-240 AC

Rated frequency [Hz]: 50

Maximum power [W]: 2 x max 40

Class of protection against electric shock: I

Lampshade material: glass

Light source: G9

Cap: G9

Ambient temperature range to which the product can be exposed: 5÷25

Enclosure material: steel

Connection type: Bolt terminal block

Range of sections of wires used [mm²]: 1÷2,5

The fixture is movable horizontally [°]: 320

The fixture is movable vertically [°]: 90

IP class: 20

LOGISTIC DATA:

Unit of measurement: unit

Packaging method: 12

Number of units in the secondary packaging: 1

Number of units in the packaging: 12

Net unit weight [g]: 876

Grammage [g]: 1154.17

Length of a unit pack [cm]: 14

Width of a unit pack [cm]: 10.5

Height of a unit pack [cm]: 37.5

Weight of a cardboard box [kg]: 13.85004

19641 GLASO EL-2I

Wall & ceiling lighting fitting



Width of a cardboard box [cm]: 33

Height of a cardboard box [cm]: 39

Length of a cardboard box [cm] : 56

Volume of a cardboard box [m³]: 0.072072